

SPECIFICATIONS

CURRENT RATING	1 AMP
INSULATOR RESISTANCE	1000 MEGOHMS MIN
CONTACT RESISTANCE	20m OHM MAX
DIELECTRIC WITHSTANDING	AC 300V
OPERATING TEMPERATURE	-40° TO +105°C
CONTACT MATERIAL	PHOSPHOR BRONZE
INSULATOR MATERIAL	THERMOPLASTIC,UL 94V-0
	STANDARD: LCP

PLATING      GOLD, TIN OR SELECTIVE OVER 30~50U" NICKEL

SOLDERABILITY      IR REFLOW: 280°C FOR 10 SEC

                              WAVE: 250°C FOR 5-10 SEC

                              MANUAL SOLDER: 380°C FOR 3-5 SEC

PACKED IN TUBE OR TRAY

NOTES:

1. RECOMMENDED MATING PIN LENGTH : 2.0MM-4.0MM.

MATES WITH: - (0.40MM SQUARE PINS)

BB02-NA    BB02-NS

                  BB02-NB    BB02-5B

                  BB02-NC

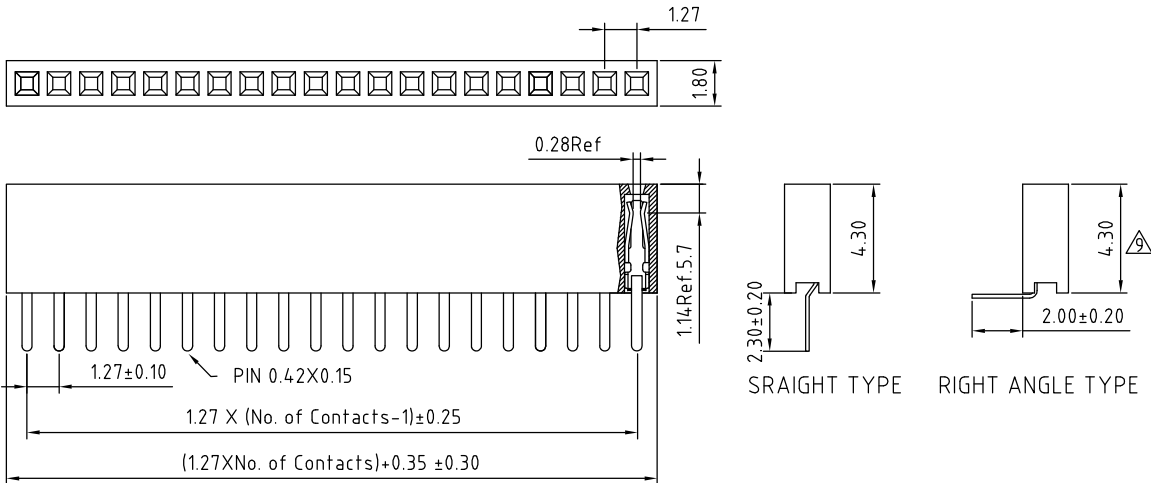

HOW TO ORDER

B

B

0

2

 - 

C

T

X

X

2

 - 

X

0

3

 - 

X

0

0

0

0

0

NO OF CONTACTS:  
02 TO 40

CONTACT PLATING OPTIONS:  
K = GOLD FLASH (STANDARD)  
A = 10U" GOLD ON CONTACT/GOLD FLASH ON TAIL  
B = 15U" GOLD ON CONTACT/GOLD FLASH ON TAIL  
C = 30U" GOLD ON CONTACT/GOLD FLASH ON TAIL  
T = BRIGHT TIN  
M = MATT TIN  
D = GOLD FLASH ON CONTACT/BRIGHT TIN ON TAIL

CONNECTOR TYPE:  
S = STRAIGHT  
R = RIGHT ANGLE

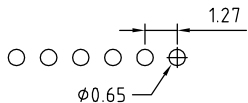

RECOMMENDED PC BOARD LAYOUT  
(TOLERANCE: ±0.05)